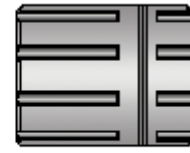
Kit 991-238
(Option E)

The momentary/twist manual override is a rotary, hand-actuated device for use on Sun's full flow solenoid valves and certain Series P models. The hand knob is constructed of a reinforced plastic for durability, heat resistance and stability in varying environmental conditions and is suitable for operation with a gloved hand. The override assembly incorporates a sealed-construction design thereby preventing the introduction of debris and other damaging contamination. Once installed on a Sun solenoid valve, the override feature allows the operator to manually shift the de-energized valve. Solenoid cartridges may be ordered in this configuration by specifying an "E" control in the cartridge model number. Sun kits for field conversion are also available. Please note that valves with the momentary/twist manual override are not suitable for load holding applications.

- NOTES:**
- Ensure o-ring is installed in bottom of the manual override assembly.
 - Remove existing coil nut from end of solenoid tube.
 - Thread the manual override assy on to the end of the solenoid tube. Point coil connector in desired position before hand tightening the manual override assy.
 - Note: Thread lock may be used if anticipated conditions warrant.