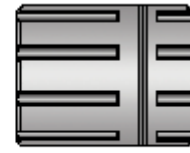
Kit 991-238  
(Option E)

The momentary/twist manual override is a rotary, hand-actuated device for use on Sun's full flow solenoid valves and certain Series P models. The hand knob is constructed of a reinforced red plastic for durability, heat resistance and stability in varying environmental conditions and is suitable for operation with a gloved hand. The override assembly incorporates a sealed-construction design thereby preventing the introduction of debris and other damaging contamination. Once installed on a Sun solenoid valve, the override feature allows the operator to manually shift the de-energized valve. The red E control is available in kit form only and cannot be configured with the cartridge. Please note that valves with the Twist/Lock manual override are not suitable for load holding applications.

- NOTES:**
- Ensure o-ring is installed in bottom of the manual override assembly.
  - Remove existing coil nut from end of solenoid tube.
  - Thread the manual override assy on to the end of the solenoid tube. Point coil connector in desired position before hand tightening the manual override assy.
  - Note: Thread lock may be used if anticipated conditions warrant.