

**CONFIGURATION**

- X \_\_\_\_\_
- A 4 psi (0,3 bar) \_\_\_\_\_
- N \_\_\_\_\_

0.162 LOCATING SHOULDER

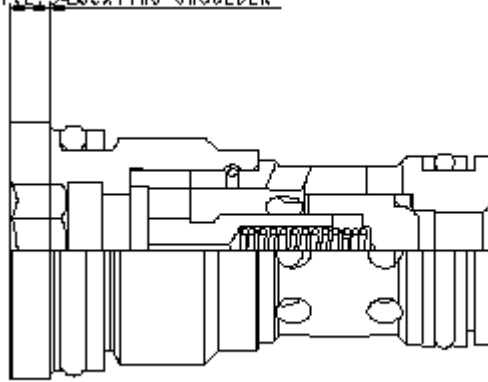

PORT2

/ 1 2

**TECHNICAL DATA** NOTE: DATA MAY VARY BY CONFIGURATION. SEE CONFIGURATION SECTION.

	T-162DP
	0
	40 L/min.
	350 bar
110 SUS (24 cSt)	0,07 cc/min.
	8 mm
	27 - 33 Nm
	0.03 kg.
Seal kit - Cartridge	Buna: 990-162-007
Seal kit - Cartridge	EPDM: 990-162-014
Seal kit - Cartridge	Polyurethane: 990-162-002
Seal kit - Cartridge	Viton: 990-162-006

# OPTION SELECTION EXAMPLE: CXBMXAN

(X)

(A)

(N)

**X**

**A** 4 psi (0,3 bar)

**N**

**B** 15 psi (1 bar)

**E** EPDM

**C** 30 psi (2 bar)

**V**

## TECHNICAL FEATURES

- T-162DP
- 
- 
- 1 0.07cc/min
- 2 5000psi 350bar
- EPDM
- Sun

## PERFORMANCE CURVES

