

TECHNICAL DATA NOTE: DATA MAY VARY BY CONFIGURATION. SEE CONFIGURATION SECTION.

Body Type	montaje en línea
Capacity	480 L/min.
Control Flow Range	1 - 200 L/min.
Mounting Hole Thread	.375-16 UNC - 2B in.
Mounting Hole Depth	22,4 mm
Mounting Hole Quantity	3

OPTION SELECTION EXAMPLE: XQILLANBN

CONTROL		(L) ADJUSTMENT RANGE	(A) SEAL MATERIAL	(N)
L	Standard Screw Adjustment	A 1000 - 3000 psi (70 - 210 bar), 1000 psi (70 bar) Standard Setting	N Buna-N	V Viton
C	Tamper Resistant - Factory Set			
K	manilla			
PRIMARY CARTRIDGE				(B)
B	20% (with QPAB primary cartridge, 20%, detector de presión en el acumulador, descargador de bomba válvula - capacidad de pilotaje)			
E	10% (with QPAE primary cartridge, 10%, detector de presión en el acumulador, descargador de bomba válvula - capacidad de pilotaje)			
D	50% (with QPAD primary cartridge, 50%, detector de presión en el acumulador, descargador de bomba válvula - capacidad de pilotaje)			
C	30% (with QPAC primary cartridge, 30%, detector de presión en el acumulador, descargador de bomba válvula - capacidad de pilotaje)			
A	15% (with QPAA primary cartridge, 15%, detector de presión en el acumulador, descargador de bomba válvula - capacidad de pilotaje)			

INCLUDED COMPONENTS

Part	Description	Quantity
A330-006-006*	SAE Plug	2
A330-006-012*	SAE Plug	1
CXHAXCN	Cartridge	1
FVFAXAN	Cartridge	1
LPBDXDN	Cartridge	1
QPABLAN	Cartridge - Primary	1
RDJFXAN	Cartridge	1
XZCCXXN	Cartridge	1
XZOCXXN	Cartridge	1

MANIFOLD FACES

FACE GRID

1	2	3	4
5	6	7	8
9	10	11	12

FACE 2

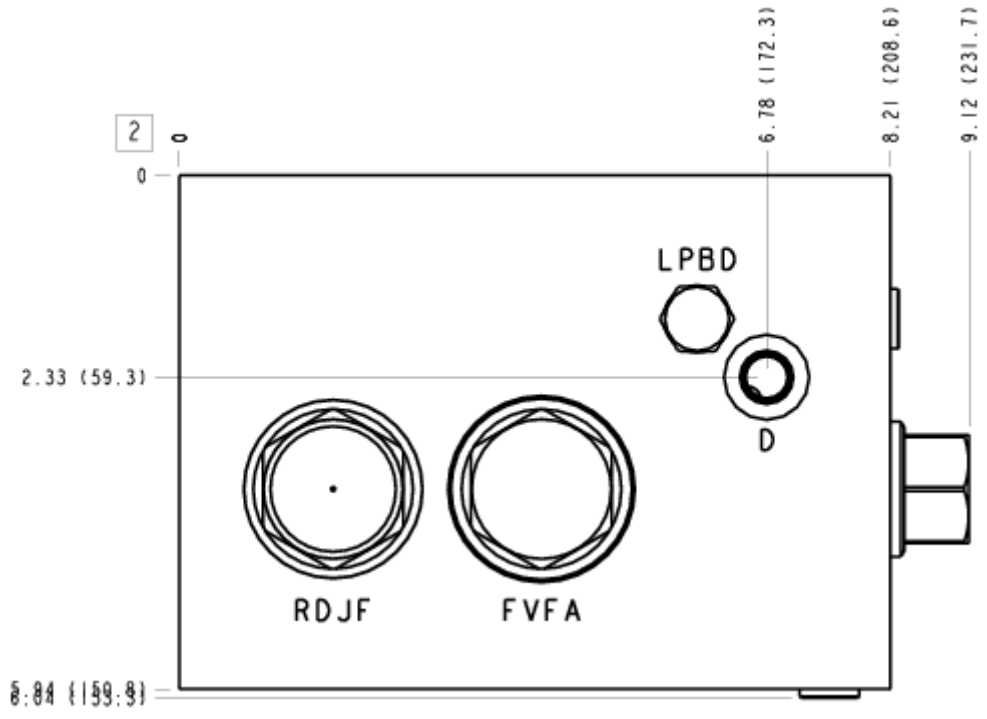

FACE 5

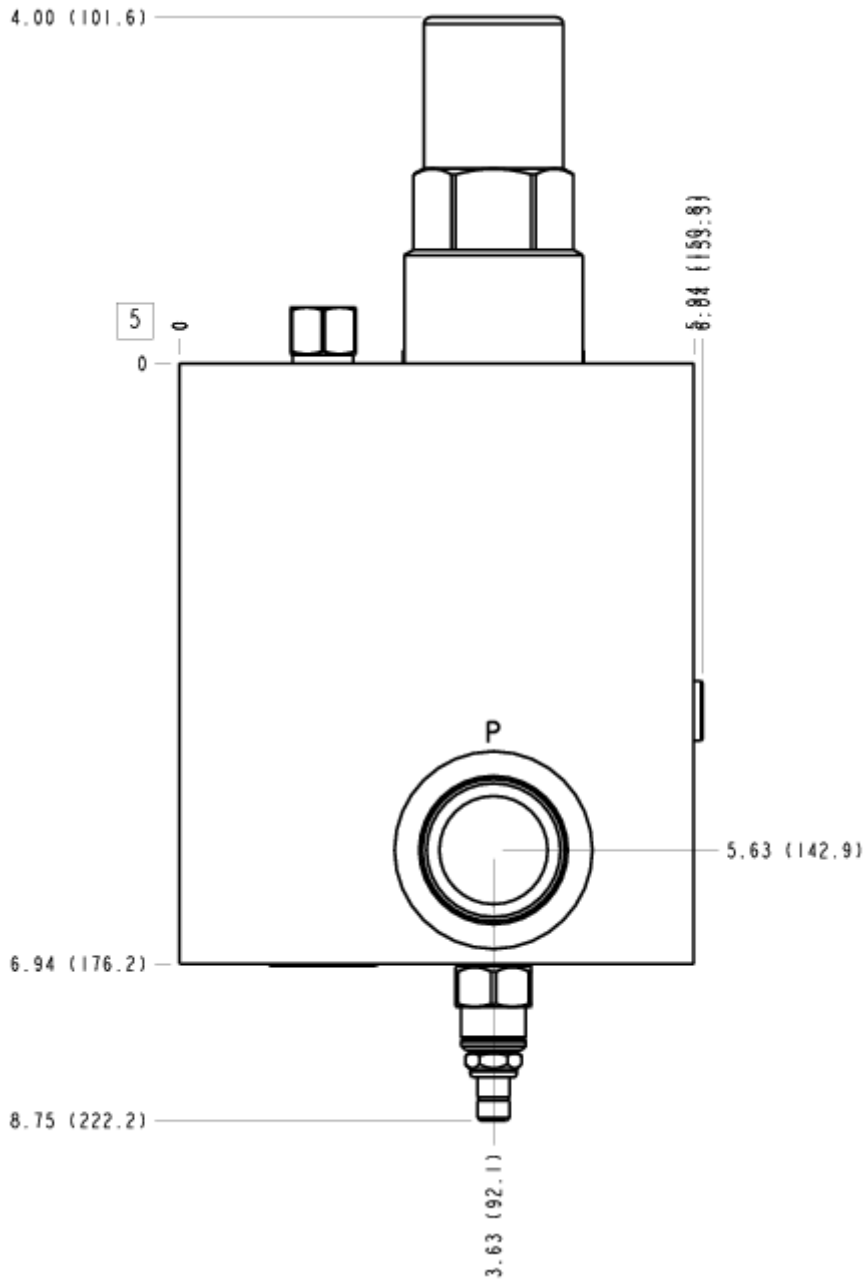

FACE 6

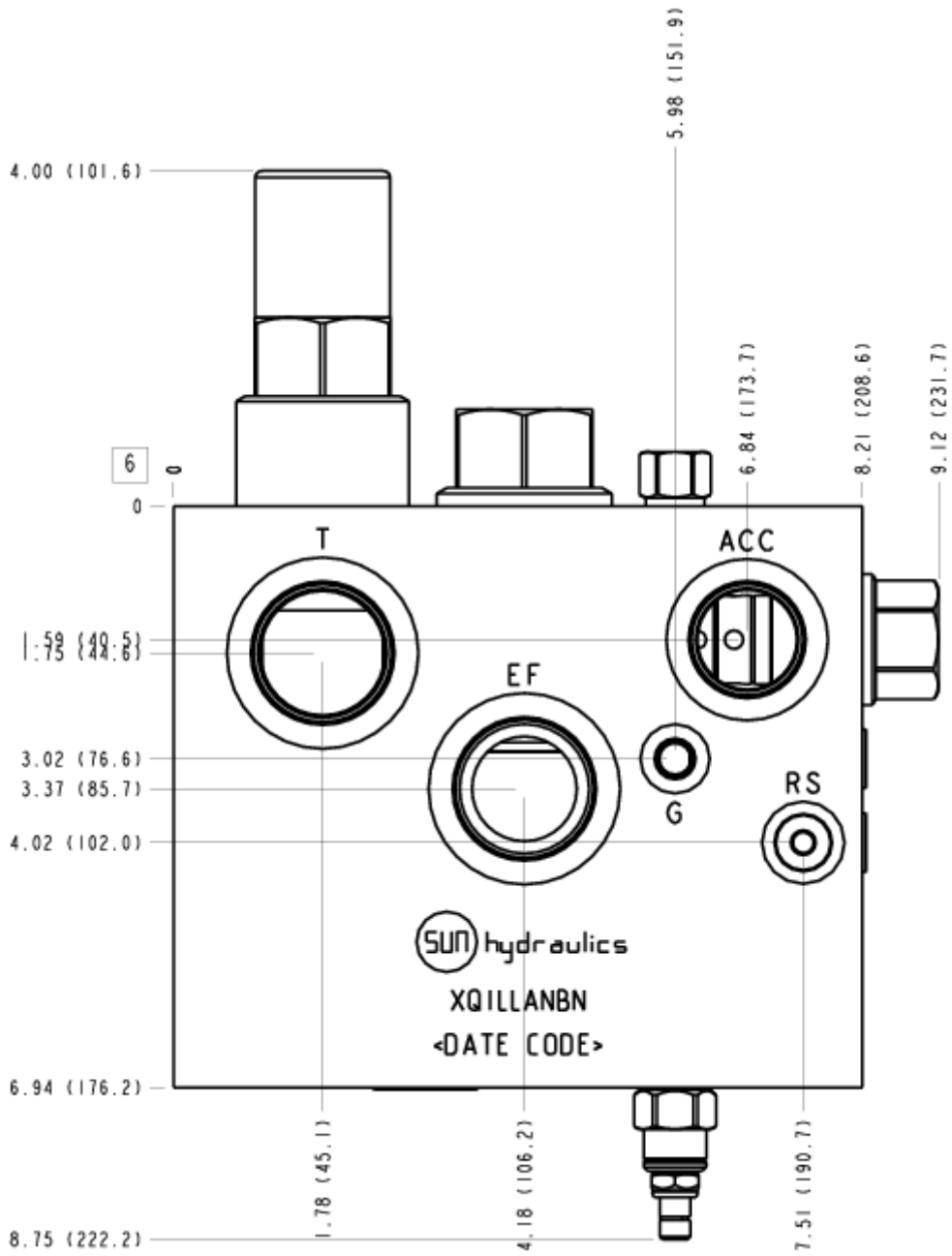

FACE 7

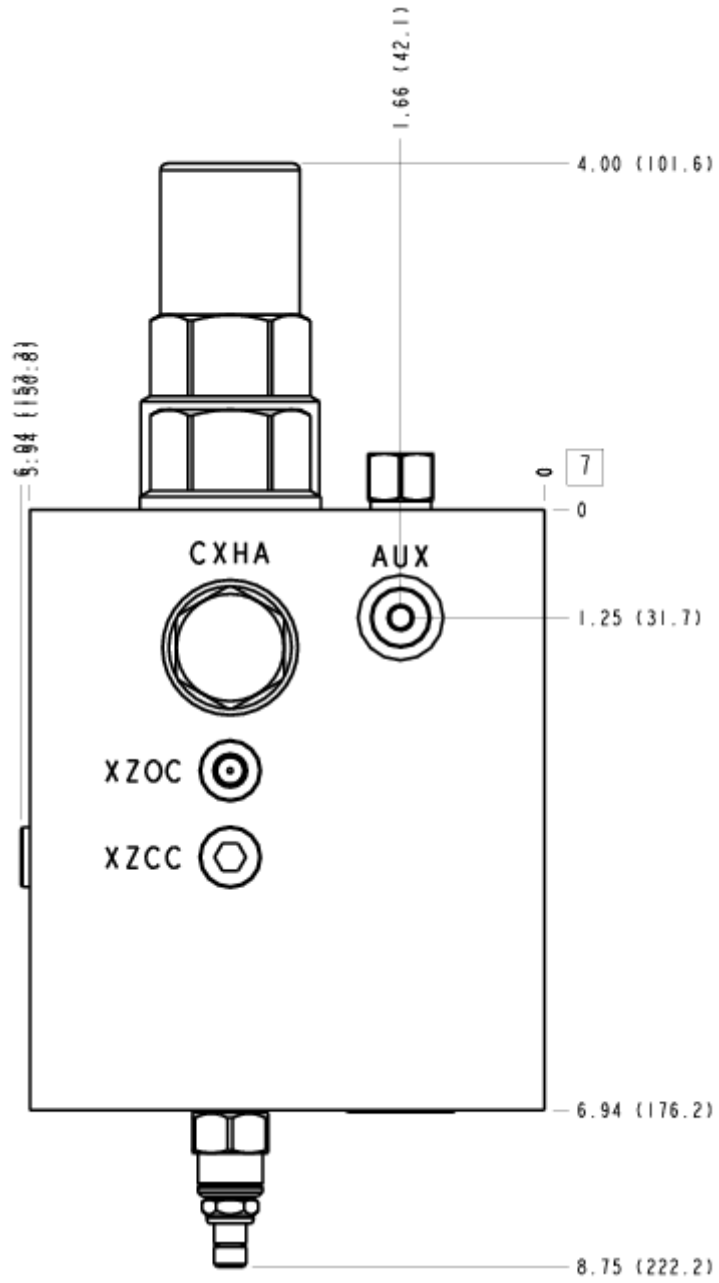

FACE 8

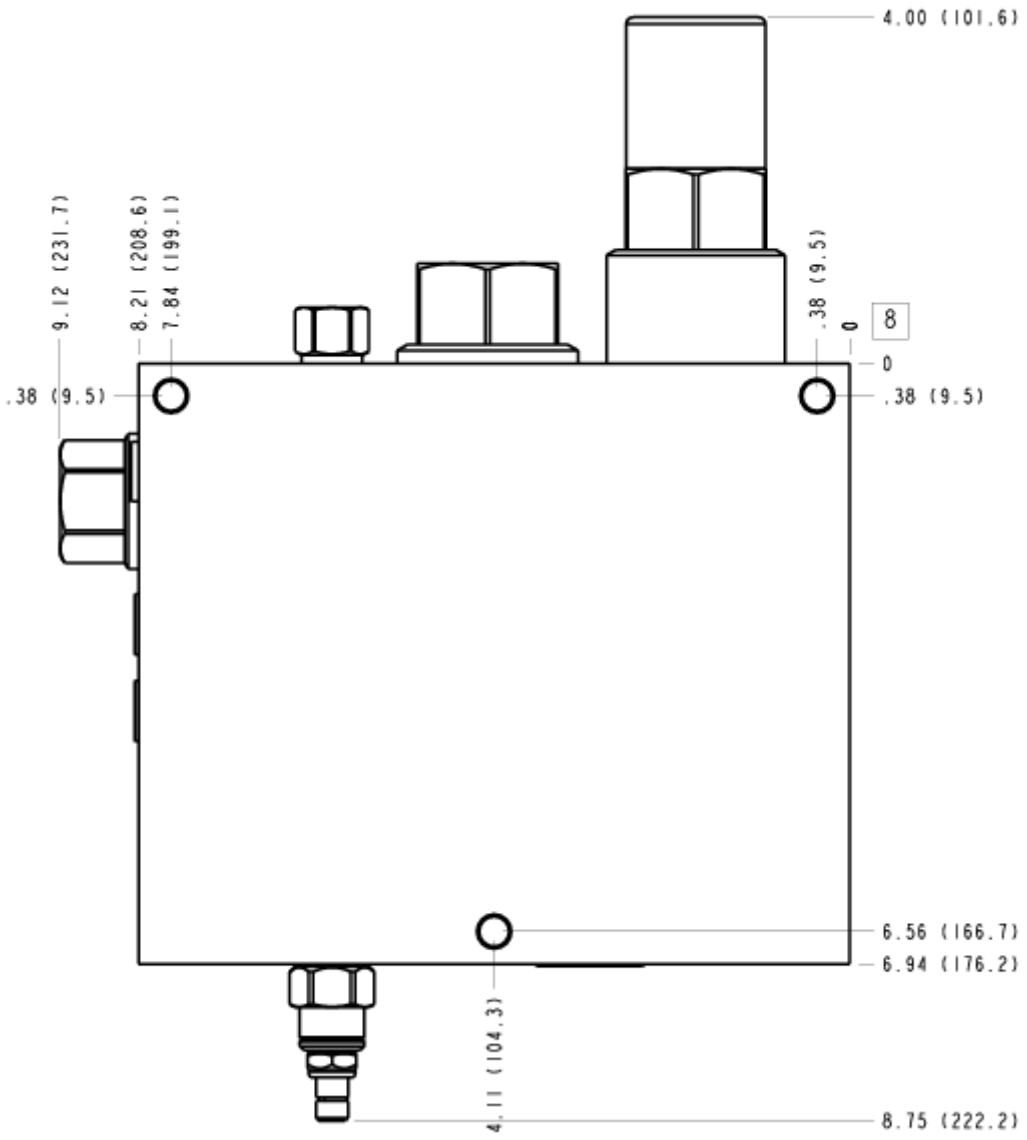

FACE 10

