

CONFIGURATION

L		
A	100 - 3000 psi (7 - 210 bar), 1000 psi (70 bar)	
N		
F	Solenoid Designation	740 Coil-Normally Open (with RVEA primary cartridge,
A	Port and Material Designation	A Aluminum
224	Coil	DIN 43650 4 pin (Hirschman) 24 VDC

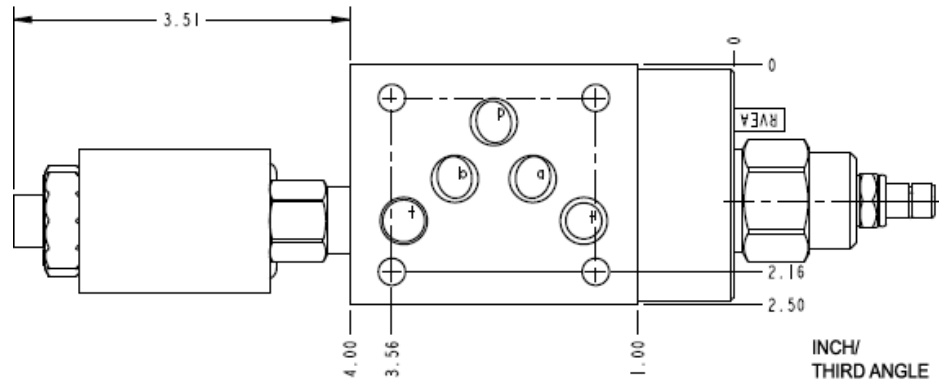

TECHNICAL DATA

	ISO 05
Stack Height	62 mm
()	
	P

CONFIGURATION OPTIONS

Model Code Example: XREDLANFA224

(L)

(A)

(N)

L	A	100 - 3000 psi (7 - 210 bar), 1000 psi (70 bar)	N
	S	25 - 200 psi (1,7 - 14 bar), 100 psi (7 bar)	V

INCLUDED COMPONENTS

Part	Description	Quantity
500-001-014*	O-Ring	5
850-004-250*	Plug	1
DTAFMHN224	Cartridge	1
RVEALAN	Cartridge - Primary	1