

TECHNICAL DATA NOTE: DATA MAY VARY BY CONFIGURATION. SEE CONFIGURATION SECTION.

Body Type	apiliables
Interface	ISO 05
Capacity	120 L/min.
Body Features	On P
Seal Plate Included (see notes)	No
Stack Height	62 mm

OPTION SELECTION EXAMPLE: XREDLANFA224

CONTROL	(L) ADJUSTMENT RANGE	(A) SEAL MATERIAL	(N)
L Standard Screw Adjustment	A 100 - 3000 psi (7 - 210 bar), 1000 psi (70 bar) Standard Setting	N Buna-N	
	J 25 - 1500 psi (1,7 - 105 bar), 1000 psi (70 bar) Standard Setting	V Viton	

INCLUDED COMPONENTS

Part	Description	Quantity
500-001-014*	O-Ring	5
850-004-250*	Plug	1
DTAFMHN224	Cartridge	1
RVEALAN	Cartridge - Primary	1

MANIFOLD FACES

FACE GRID

1	2	3	4
5	6	7	8
9	10	11	12

FACE 2

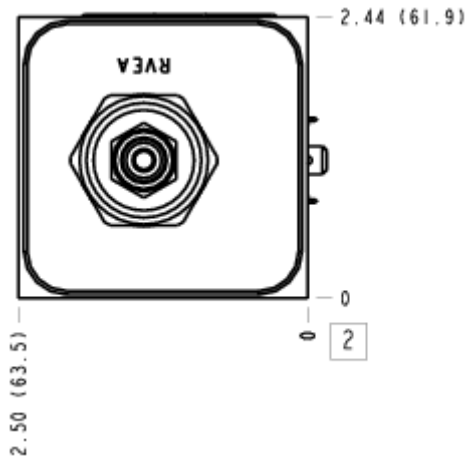

FACE 5

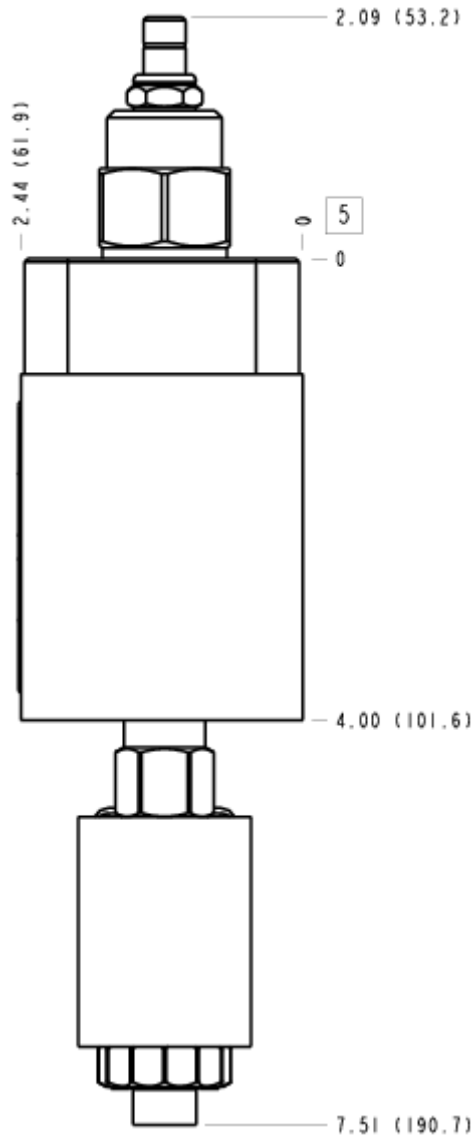

FACE 6

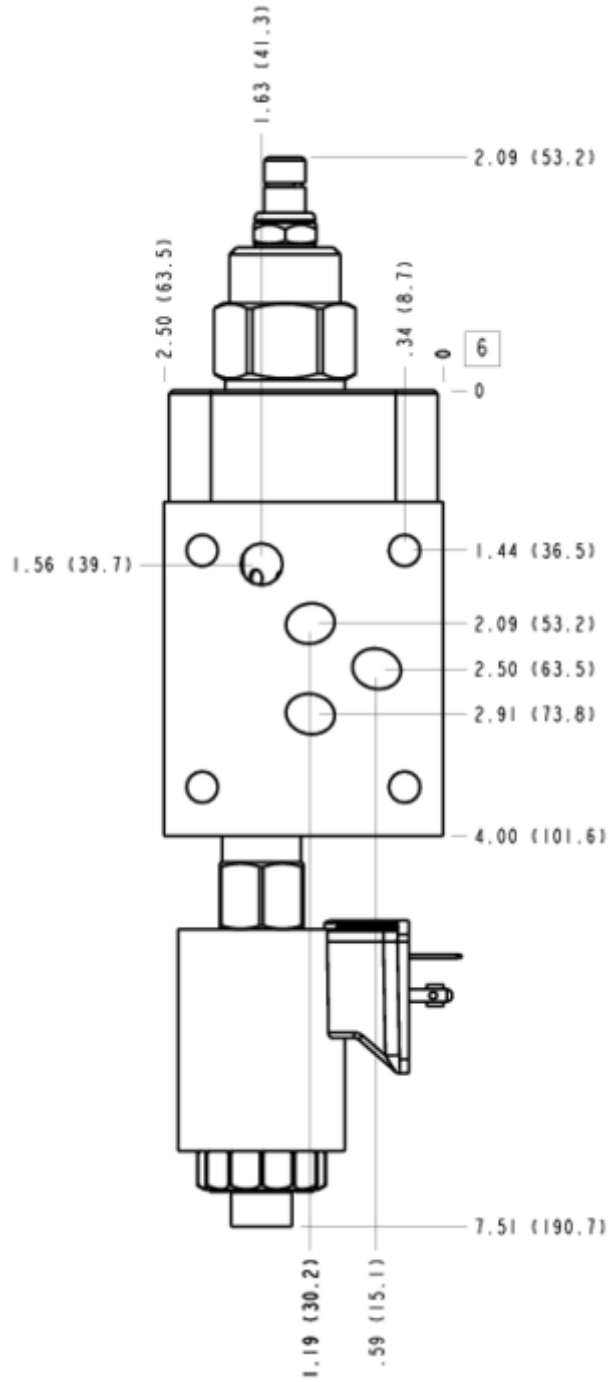

FACE 7

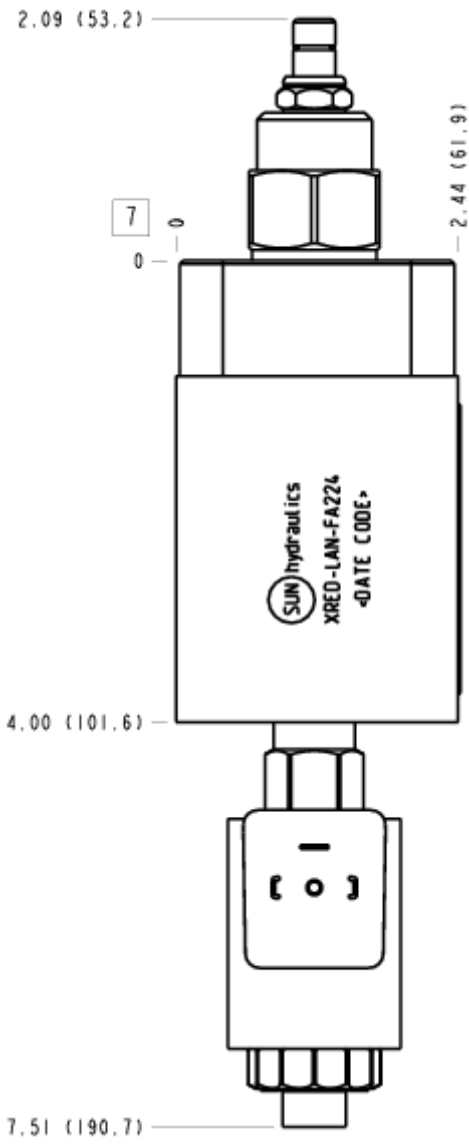

FACE 8

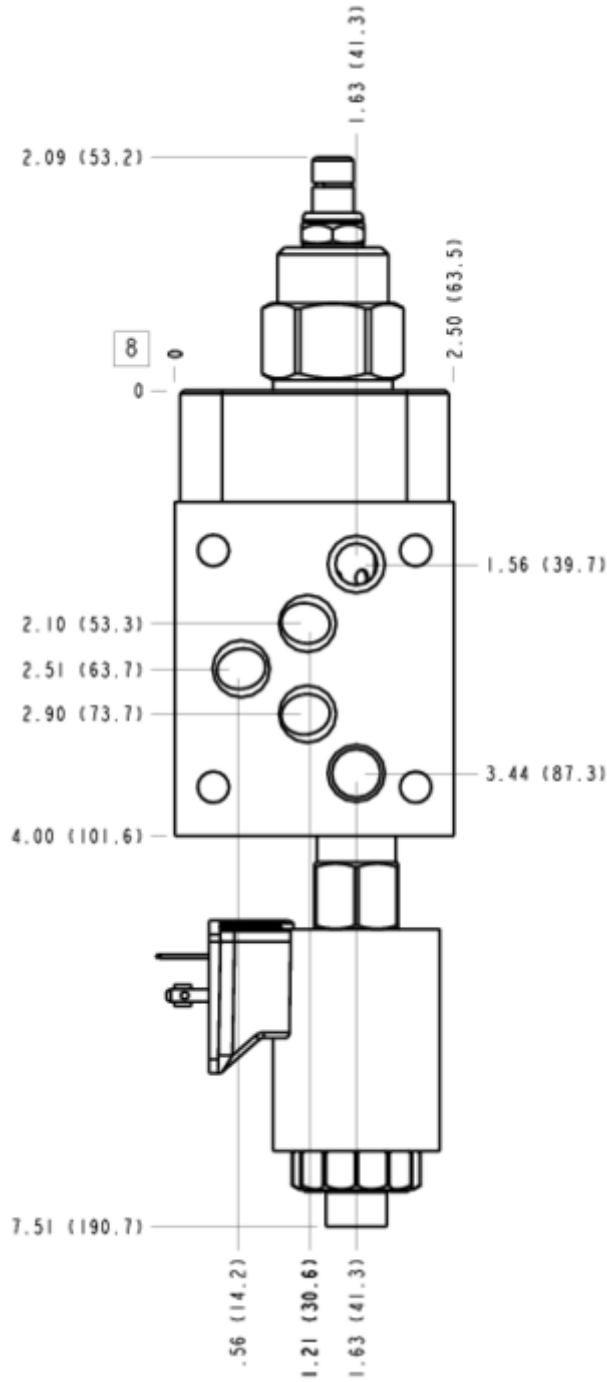

FACE 10

