

This sandwich valve assembly provides 2 functions. It relieves from pressure (p) to tank (t) when pressure at port p exceeds the setting of the valve. The solenoid control allows the valve to be vented, dropping the pressure to a minimal level. This assembly is available in both normally open option and normally closed option. The normally open option means the pressure is at a low level until the solenoid is energized. The normally closed option means the pressure is at a high level until the solenoid is energized.

**TECHNICAL DATA** NOTE: DATA MAY VARY BY CONFIGURATION. SEE CONFIGURATION SECTION.

Body Type	Sandwich
Series	
Interface	ISO 07
Capacity	60 gpm
Body Features	P to T

- NOTES:**
- **Important:** Carefully consider the maximum system pressure. The pressure rating of the manifold is dependent on the manifold material, with the port type/size a secondary consideration. Manifolds constructed of aluminum are not rated for pressures higher than 3000 psi (210 bar), regardless of the port type/size specified.
  - For detailed information regarding the cartridges contained in this assembly, click on the models codes shown in the Included Components tab.

**OPTION SELECTION EXAMPLE: XRFILANFA224**

CONTROL	(L) ADJUSTMENT RANGE	(A) SEAL MATERIAL	(N)
L Standard Screw Adjustment	A 100 - 3000 psi (7 - 210 bar), 1000 psi (70 bar) Standard Setting	N Buna-N V Viton	

**INCLUDED COMPONENTS**

Part	Description	Quantity
340-003*	Pipe Plug	1
500-001-111*	O-Ring	2
500-001-118*	O-Ring	4
700-006*	Seal Plate	1
811-001-006*	Pin	2
DTAFMHN224	Cartridge	1
RVGALAN	Cartridge - Primary	1

**TECHNICAL FEATURES**

- This assembly is well suited to loading and unloading a pump.
- The nature of a vented relief is that it brings the pressure up in a smooth manner. Unloading is abrupt.
- Now available with FLeX Series solenoid valves. See CONFIGURATION section, SOLENOID DESIGNATION to specify.

**MANIFOLD FACES**

**FACE GRID**

1	2	3	4
5	6	7	8
9	10	11	12

FACE 2

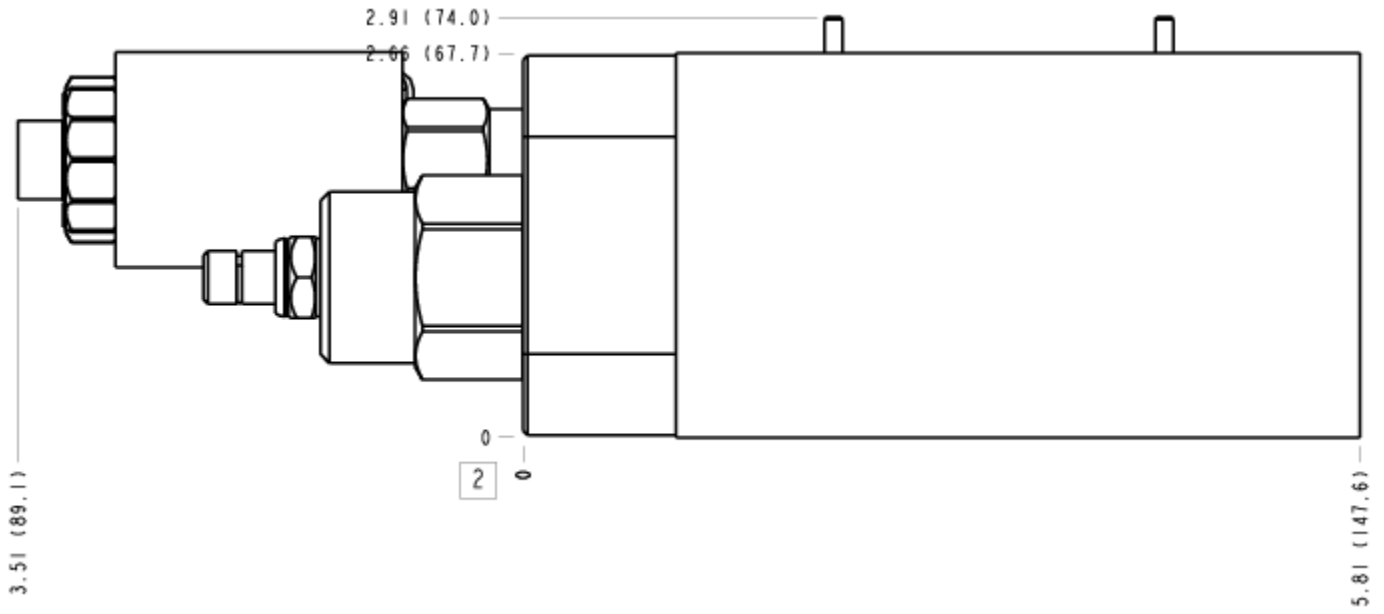

FACE 5

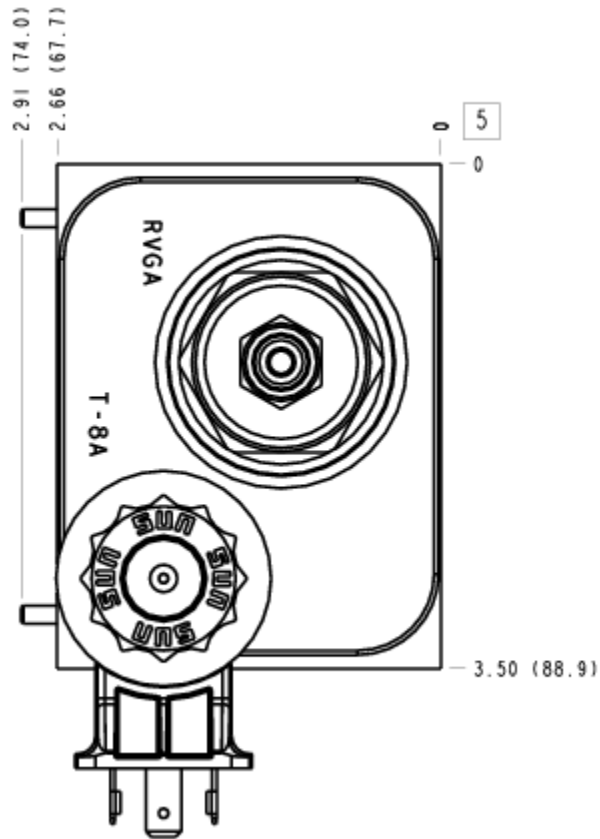

### FACE 6

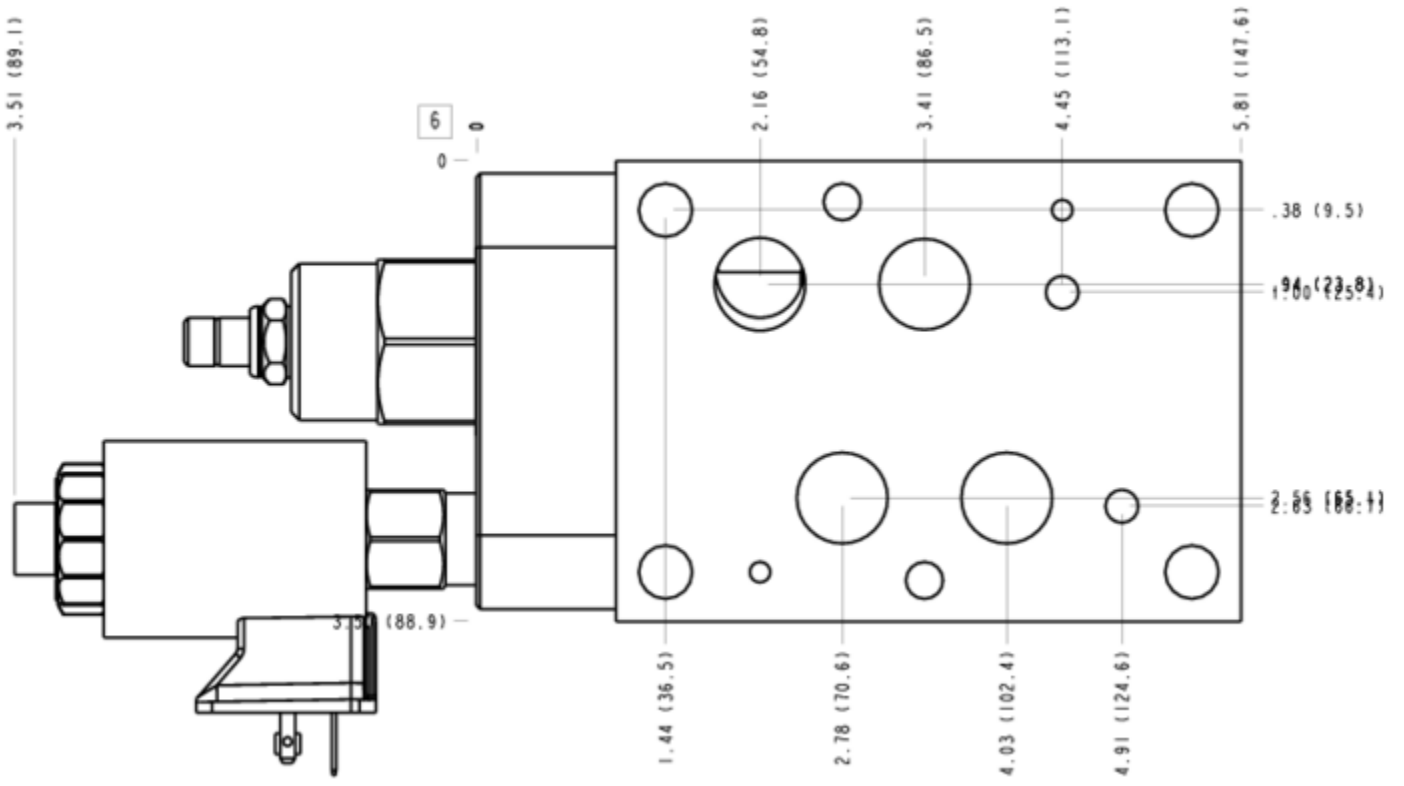

### FACE 7

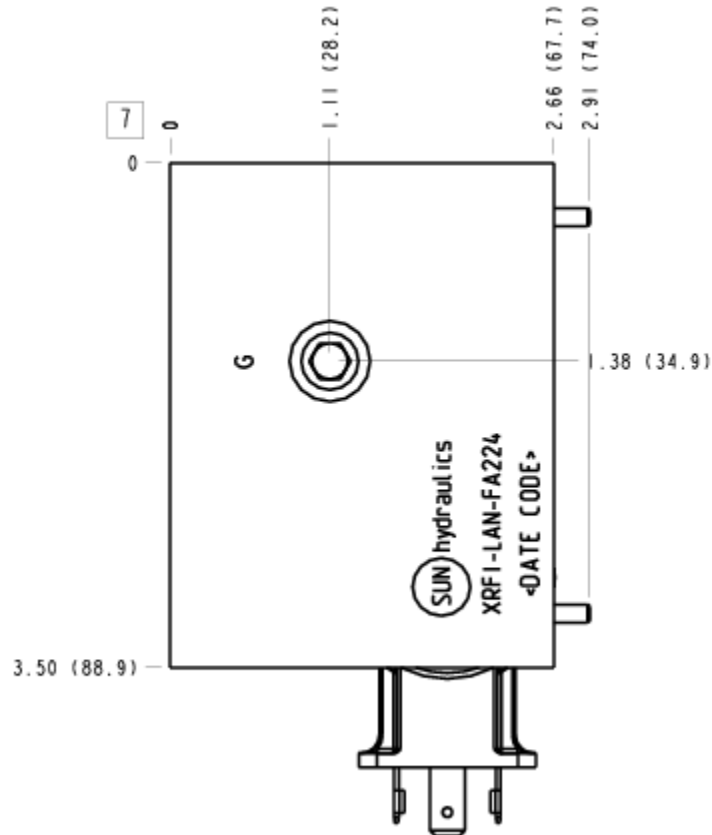

FACE 8

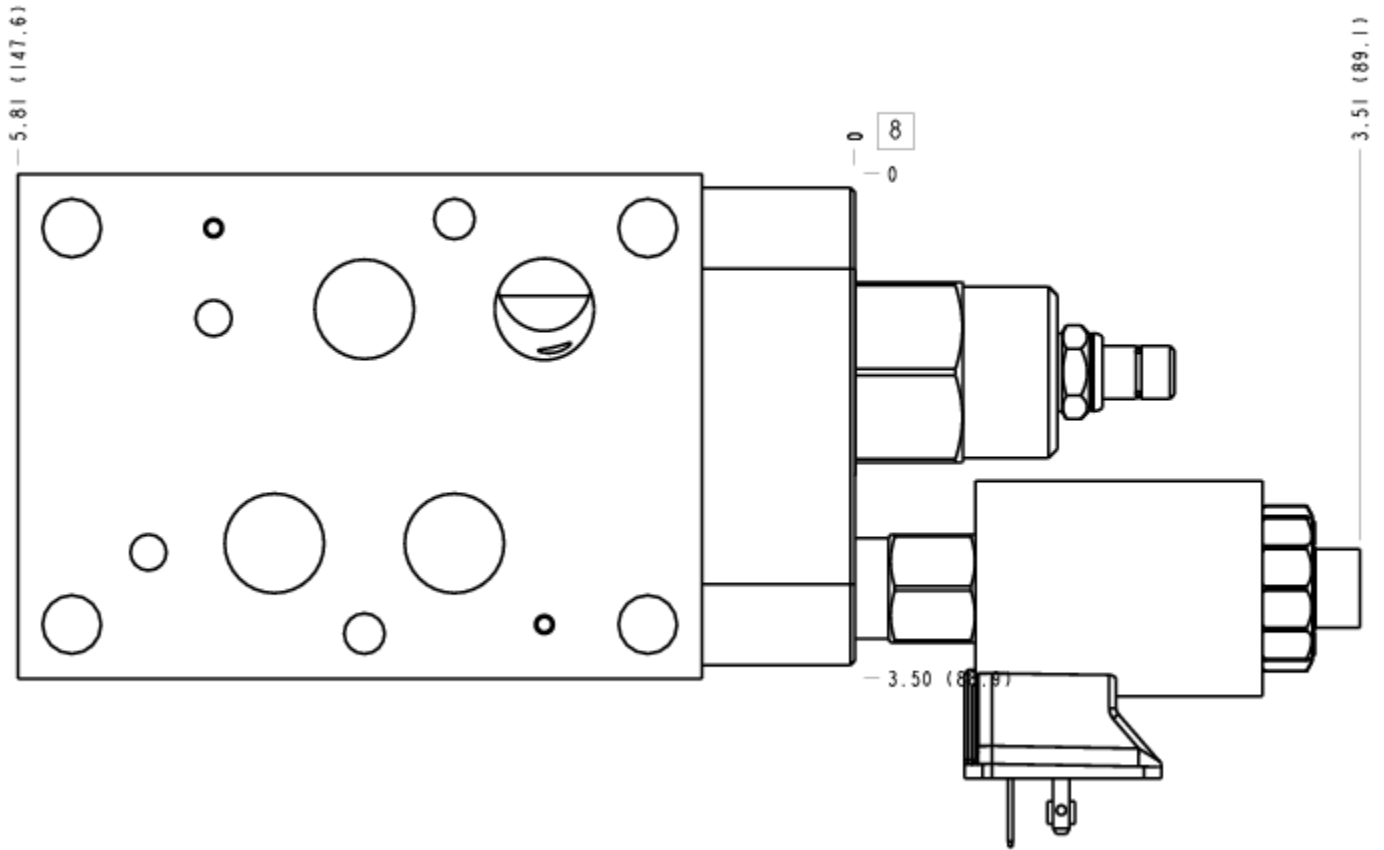

FACE 10

