

**TECHNICAL DATA** NOTE: DATA MAY VARY BY CONFIGURATION. SEE CONFIGURATION SECTION.

|           |                  |
|-----------|------------------|
| Body Type | montaje en línea |
| Capacity  | 480 L/min.       |

**OPTION SELECTION EXAMPLE: XRJCLANAM**

| CONTROL                                 | (L) ADJUSTMENT RANGE   | (A) SEAL MATERIAL | (N) |
|---|--|-------------------|-----|
| <b>L</b> Standard Screw Adjustment      | <b>A</b> 100 - 3000 psi (7 - 210 bar), 1000 psi (70 bar) Standard Setting    | <b>N</b> Buna-N   |     |
| <b>C</b> Tamper Resistant - Factory Set | <b>B</b> 50 - 1500 psi (3,5 - 105 bar), 1000 psi (70 bar) Standard Setting   | <b>V</b> Viton    |     |
| <b>K</b> manilla                        | <b>D</b> 25 - 800 psi (1,7 - 55 bar), 400 psi (28 bar) Standard Setting      |                   |     |
|   | <b>E</b> 25 - 400 psi (1,7 - 28 bar), 200 psi (14 bar) Standard Setting      |                   |     |
|   | <b>W</b> 150 - 4500 psi (10,5 - 315 bar), 1000 psi (70 bar) Standard Setting |                   |     |

**PRIMARY CARTRIDGE (A)**

|   |
|---|
| <b>A</b> A (with RPIC primary cartridge, Pilot-operated, pistón balanceado alivio válvula )   |
| A A (with RPIC8 primary cartridge, Pilot-operated, pistón balanceado alivio módulo principal con cavidad de control T-8A integral ) |

**INCLUDED COMPONENTS**

| Part    | Description         | Quantity |
|---------|---------------------|----------|
| DSIHXHN | Cartridge           | 1        |
| RPICLAN | Cartridge - Primary | 1        |

**MANIFOLD FACES**

**FACE GRID**

|   |    |    |    |
|---|----|----|----|
| 5 | 6  | 7  | 8  |
| 9 | 10 | 11 | 12 |

FACE 5

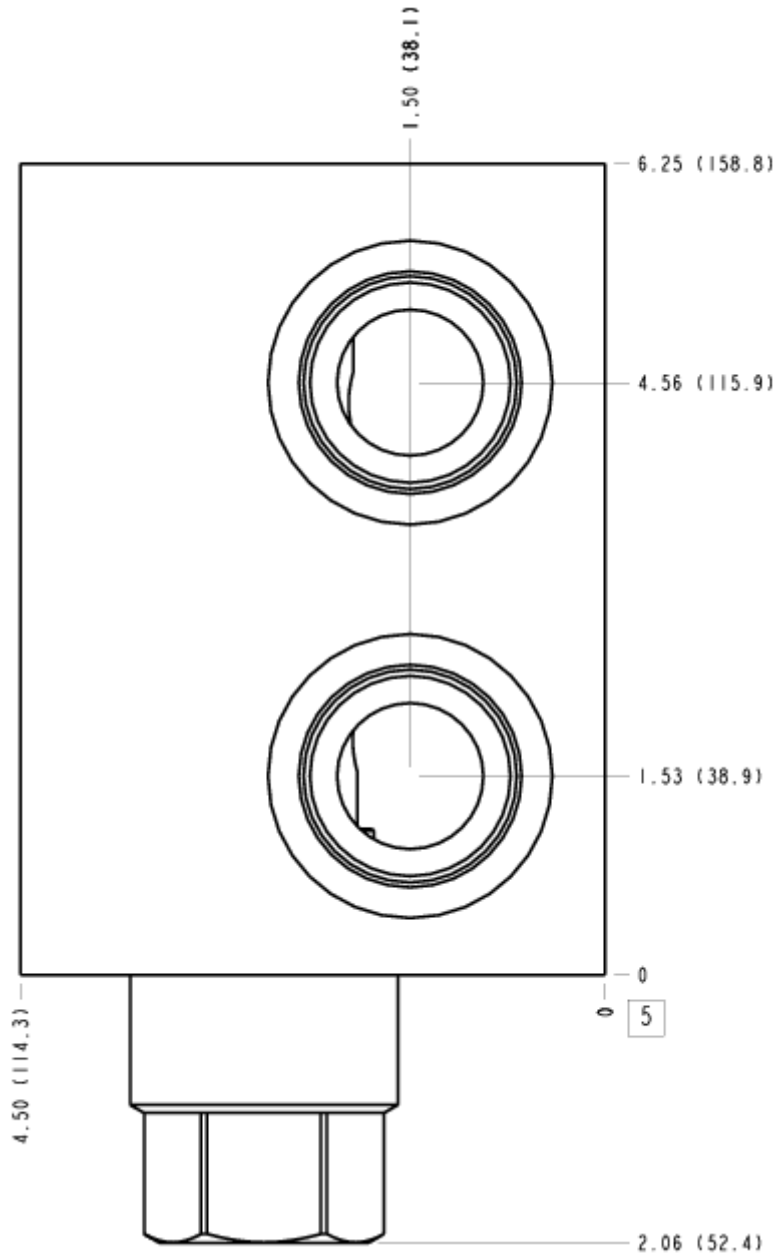

FACE 6

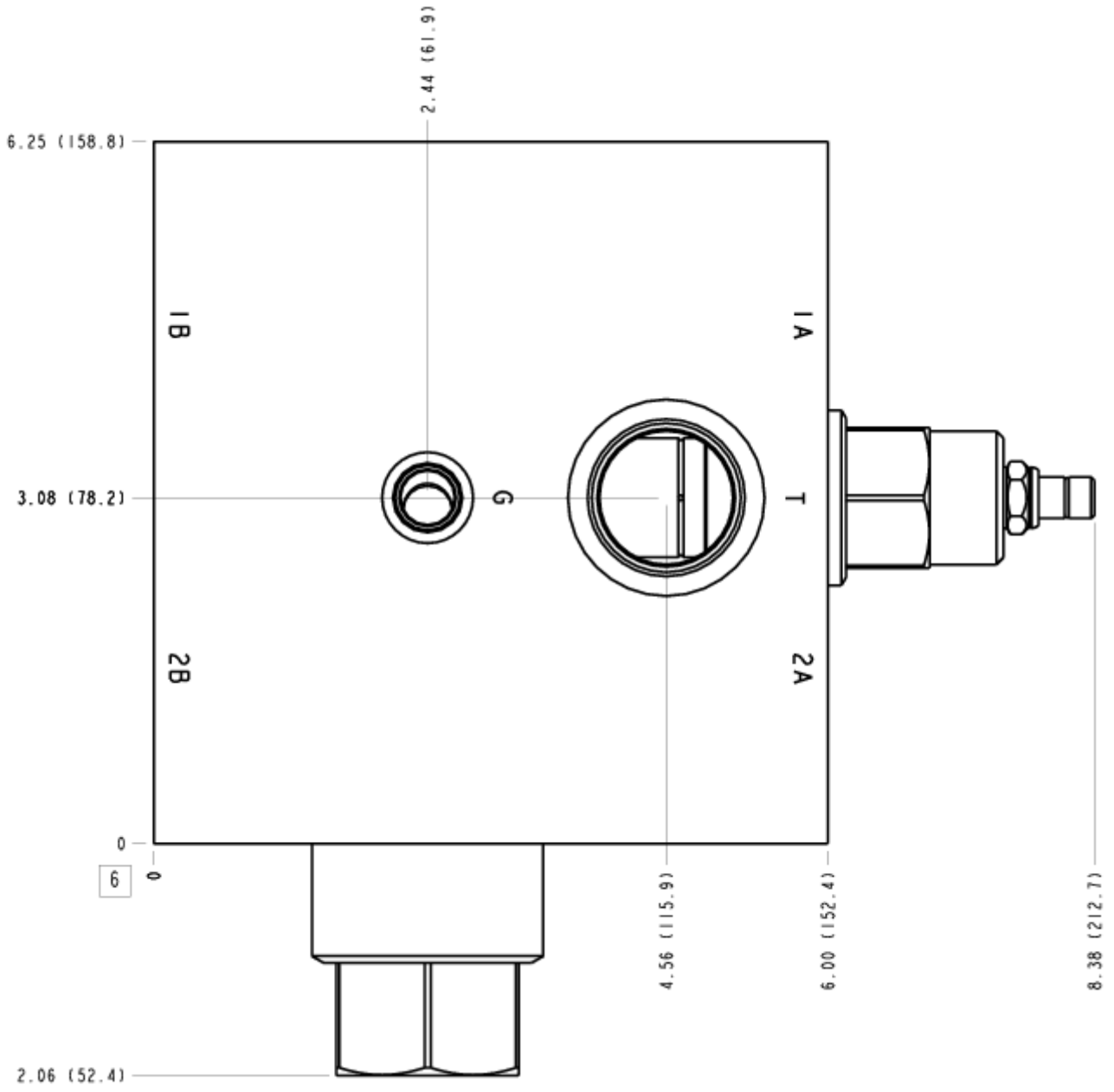

FACE 7

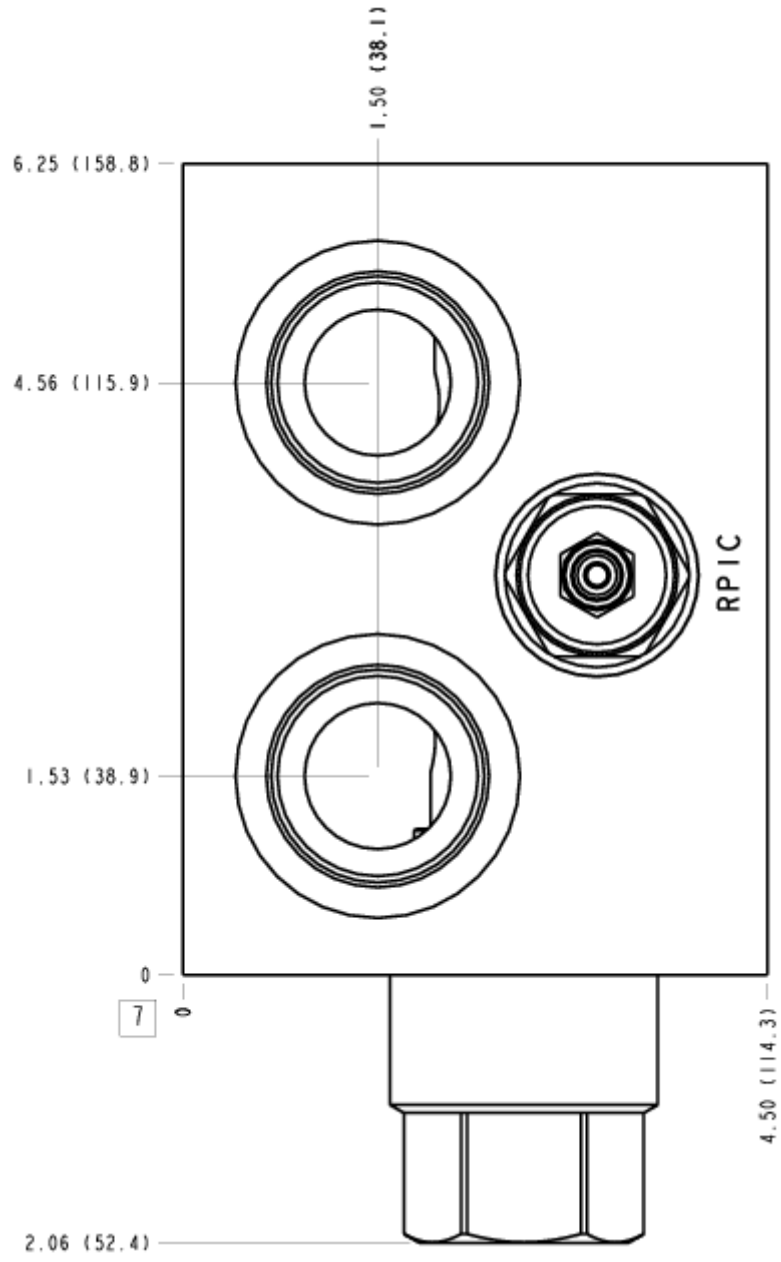

FACE 8

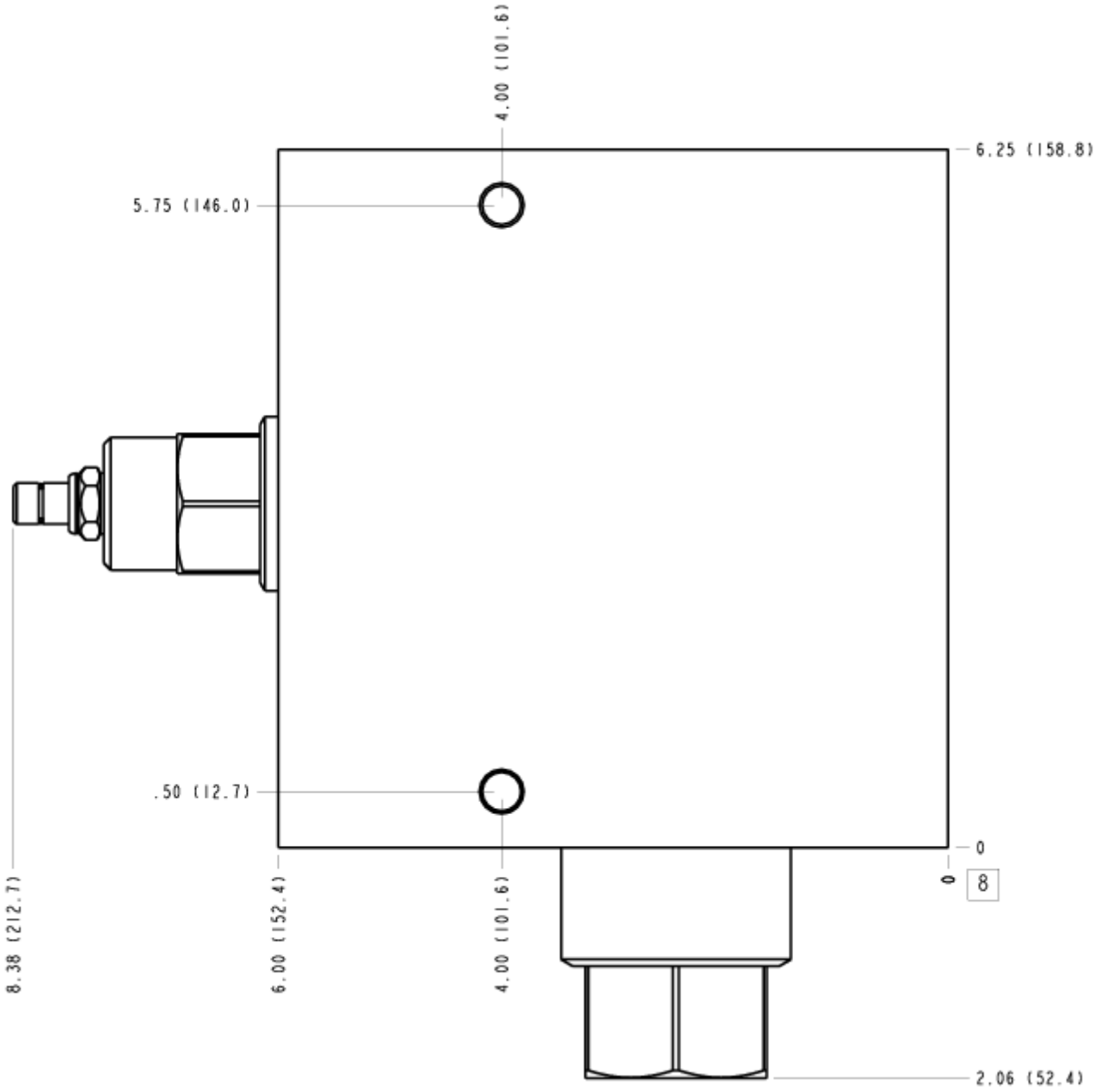

FACE 10

