

This assembly provides 2 functions, a) dual cross-pilot load holding between motor ports M1 and M2, and b) cross-port relief protection between ports M1 and M2.

TECHNICAL DATA NOTE: DATA MAY VARY BY CONFIGURATION. SEE CONFIGURATION SECTION.

Body Type	Motor mount
Interface	Eaton/Char-Lynn H & S
Capacity	15 gpm

- NOTES:**
- **Important:** Carefully consider the maximum system pressure. The pressure rating of the manifold is dependent on the manifold material, with the port type/size a secondary consideration. Manifolds constructed of aluminum are not rated for pressures higher than 3000 psi (210 bar), regardless of the port type/size specified.
 - For detailed information regarding the cartridges contained in this assembly, click on the models codes shown in the Included Components tab.

OPTION SELECTION EXAMPLE: YCCXLHNAK

CONTROL	(L) FUNCTIONAL SETTING RANGE	(H) SEAL MATERIAL	(N)
L Standard Screw Adjustment	H 1000 - 4000 psi w/25 psi Check (70 - 280 bar w/ 1,7 bar Check), 3000 psi (210 bar) Standard Setting	N Buna-N	
C Tamper Resistant - Factory Set	A 1000 - 4000 psi w/4 psi Check (70 - 280 bar w/ 0,3 bar Check), 3000 psi (210 bar) Standard Setting	V Viton	
	B 400 - 1500 psi w/4 psi Check (28 - 105 bar w/ 0,3 bar Check), 1000 psi (70 bar) Standard Setting		
	I 400 - 1500 psi w/25 psi Check (28 - 105 bar w/ 1,7 bar Check), 1000 psi (70 bar) Standard Setting		

PRIMARY CARTRIDGE (A)

A	3:1 (with CBCA primary cartridge, 3:1 pilot ratio, standard capacity counterbalance valve)
H	10:1 (with CBCHX primary cartridge, Fixed setting, 10:1 pilot ratio, standard capacity counterbalance valve)
G	4.5:1 (with CBCGX primary cartridge, Fixed setting, 4.5:1 pilot ratio, standard capacity counterbalance valve)
A	3:1 (with CBCAX primary cartridge, Fixed setting, 3:1 pilot ratio, standard capacity counterbalance valve)
H	10:1 (with CBCH primary cartridge, 10:1 pilot ratio, standard capacity counterbalance valve)
G	4.5:1 (with CBCG primary cartridge, 4.5:1 pilot ratio, standard capacity counterbalance valve)

INCLUDED COMPONENTS

Part	Description	Quantity
CBCALHN	Cartridge - Primary	2
RDDALAN	Cartridge	2

TECHNICAL FEATURES

- Counterbalance valves should be set at least 1.3 times the maximum load induced pressure.
- Turn adjustment clockwise to decrease setting of the counterbalance valve and release load.
- Backpressure at port 2 of the counterbalance valve adds to the effective relief setting at a ratio of 1 plus the pilot ratio times the backpressure.
- Counterbalance valve reseal exceeds 85% of set pressure when the valve is standard set. Settings lower than the standard set pressure may result in lower reseal percentages.
- The assembly's cross-ported direct acting relief valves exhibit rapid response characteristics that minimize pressure overshoot and also provide low reseal leakage (less than 5 drops/min (0,3 cc/min) @ 85% of cracking pressure).
- Hydraulic motors leak. Therefore a mechanical brake is recommended to positively lock any stopped live load.

MANIFOLD FACES

FACE GRID

1	2	3	4
5	6	7	8

FACE 2

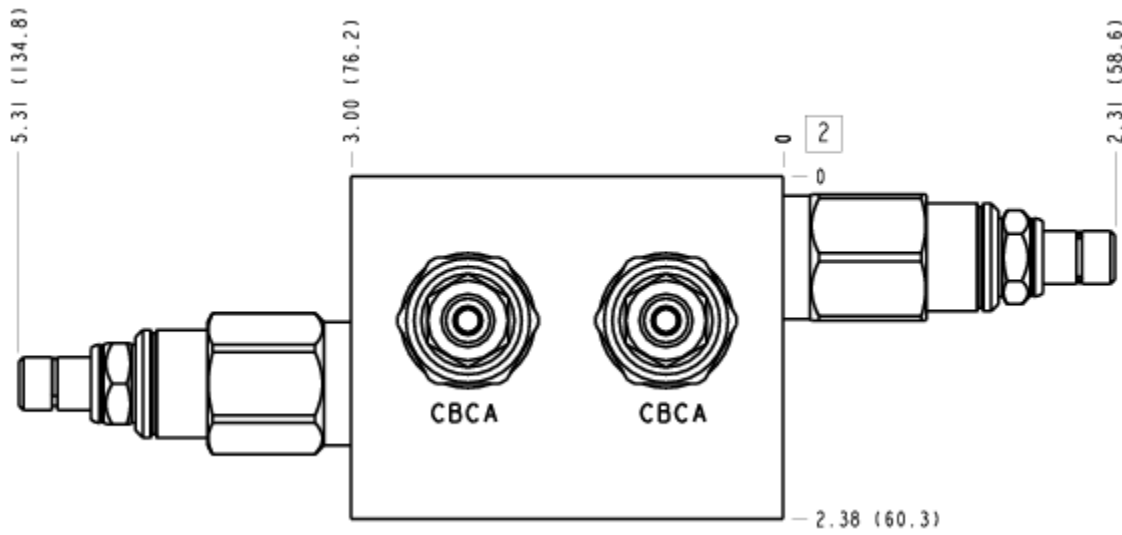

FACE 5

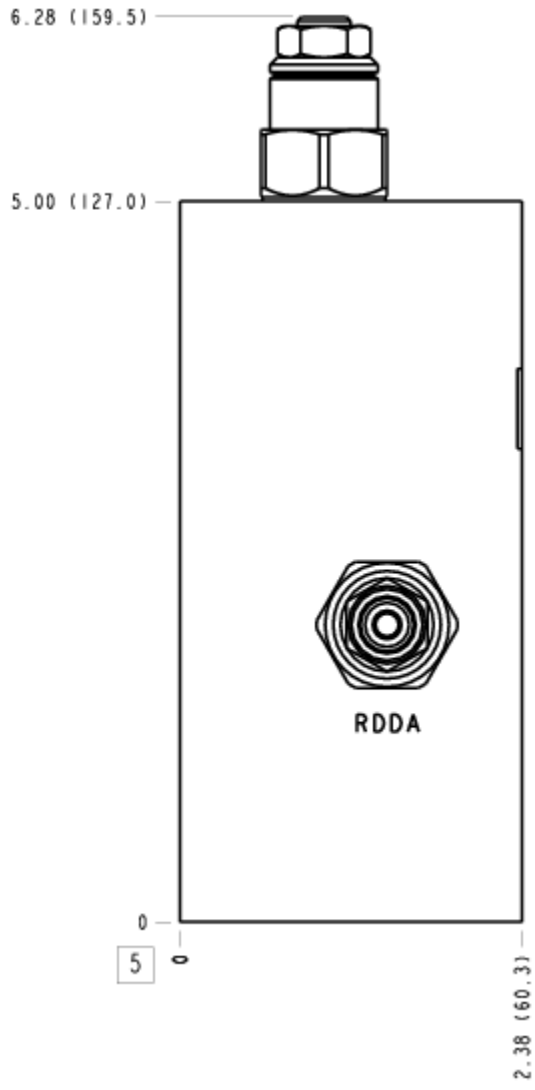

FACE 6

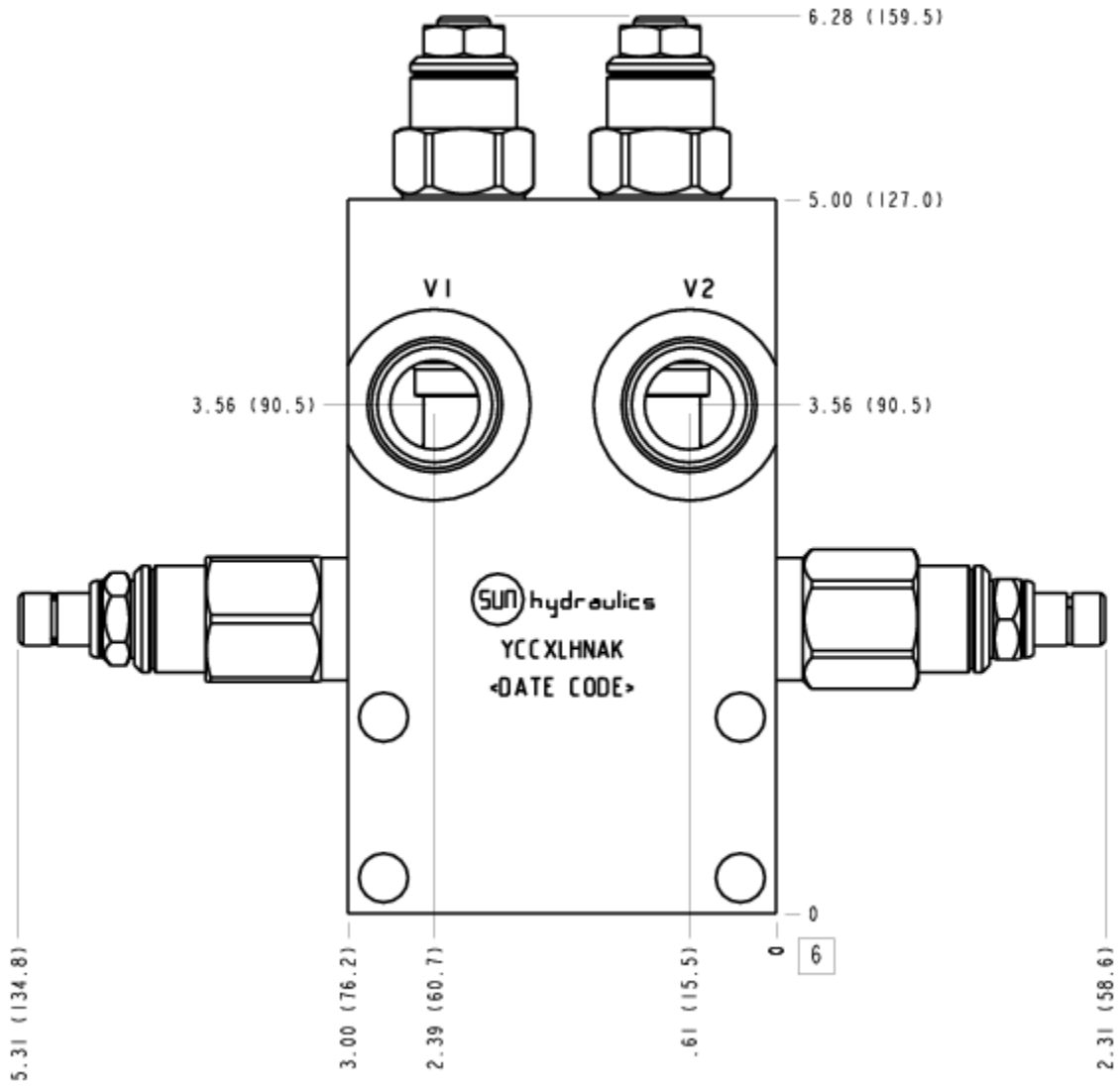

FACE 7

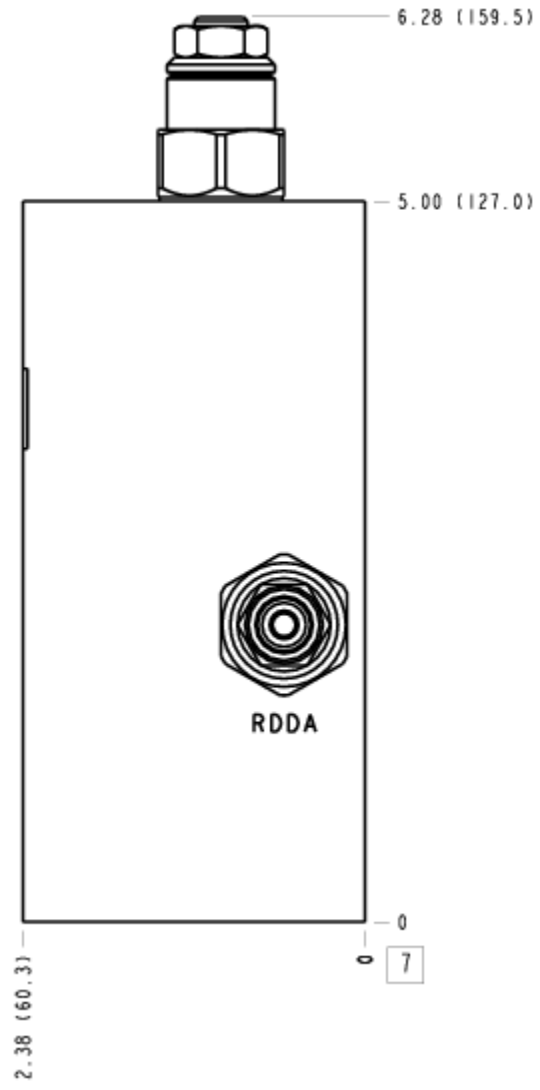

FACE 8

