

Normally Closed

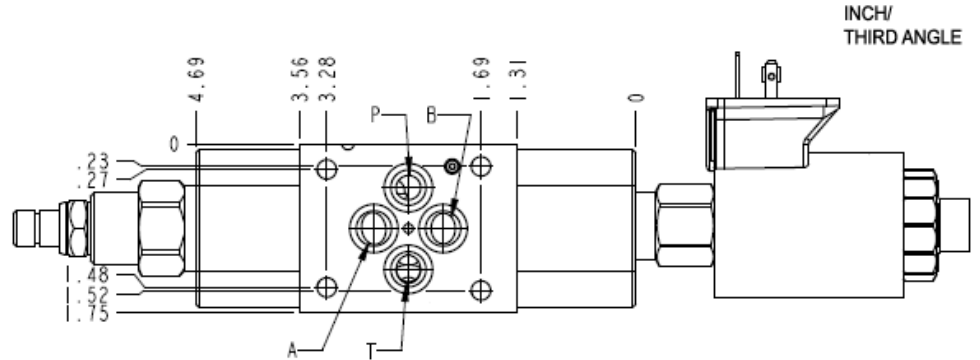

Normally Open

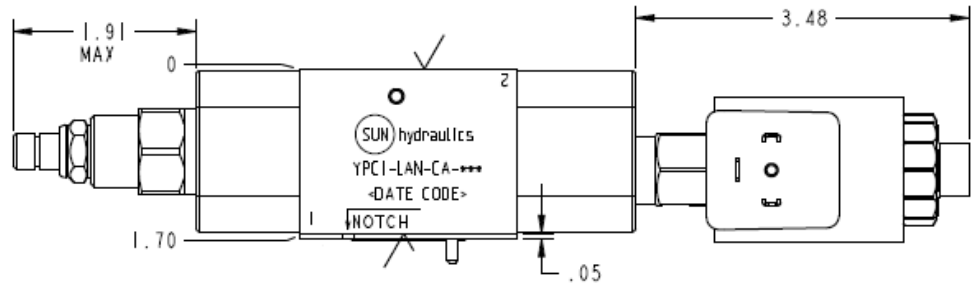

INCH/
THIRD ANGLE

CONFIGURATION OPTIONS
Model Code Example: YPCILANFA224

CONTROL		(L) ADJUSTMENT RANGE	(A) SEAL MATERIAL	(N)
L	Standard Screw Adjustment	A 100 - 3000 psi (7 - 210 bar), 200 psi (14 bar) Standard Setting	N Buna-N	
C	Tamper Resistant - Factory Set	B 50 - 1500 psi (3,5 - 105 bar), 200 psi (14 bar) Standard Setting	V Viton	
W	Hex Wrench Adjustment	D 25 - 800 psi (1,7 - 55 bar), 200 psi (14 bar) Standard Setting		
Y	manilla de tres agarres	E 25 - 400 psi (1,7 - 28 bar), 200 psi (14 bar) Standard Setting		
		N 60 - 800 psi (4 - 55 bar), 200 psi (14 bar) Standard Setting		
		Q 60 - 400 psi (4 - 28 bar), 200 psi (14 bar) Standard Setting		
		W 150 - 4500 psi (10,5 - 315 bar), 200 psi (14 bar) Standard Setting		

INCLUDED COMPONENTS

Part	Description	Quantity
500-001-012*	O-Ring	4
700-002*	Seal Plate	1
811-001-006*	Pin	1
850-004-156*	Plug	3
850-004-218*	Plug	1
DTAFMHN224	Cartridge	1
PVDALAN	Cartridge - Primary	1